

# Triaxial accelerometer with integral cable

## 993A-5

### SPECIFICATIONS

<b>Sensitivity, <math>\pm 10\%</math>, 25°C</b>	100 mV/g
<b>Acceleration range</b>	50 g peak
<b>Amplitude nonlinearity</b>	1%
<b>Frequency response:</b>	
all channels, $\pm 10\%$	2 - 2,000 Hz
<b>Transverse sensitivity, max</b>	5% of axial
<b>Temperature response:</b>	
-50°C	+10%
+25°C	0%
+80°C	+3%
+120°C	-7%
<b>Power requirement:</b>	
Voltage source	18 - 30 VDC
Current regulating diode	2 - 10 mA
<b>Electrical noise, equiv. g:</b>	
Broadband 2.5 Hz to 25 kHz	150 $\mu$ g
Spectral 10 Hz	20 $\mu$ g/ $\sqrt{\text{Hz}}$
100 Hz	2.0 $\mu$ g/ $\sqrt{\text{Hz}}$
1,000 Hz	0.6 $\mu$ g/ $\sqrt{\text{Hz}}$
<b>Output impedance, max</b>	100 $\Omega$
<b>Bias output voltage</b>	12 VDC
<b>Grounding</b>	case isolated, internally shielded
<b>Temperature range</b>	-50° to +120°C
<b>Vibration limit</b>	500 g peak
<b>Shock limit</b>	5,000 g peak
<b>Electromagnetic sensitivity, equiv. g</b>	100 $\mu$ g/gauss
<b>Sealing</b>	epoxy
<b>Base strain sensitivity</b>	0.002 g/ $\mu$ strain
<b>Sensing element design</b>	PZT, shear
<b>Weight</b>	90 grams
<b>Case material</b>	hardcoated aluminum
<b>Mounting</b>	10-32 captive screw
<b>Recommended cabling</b>	J98 integral cable, 6 ft.

Accessories supplied: #11085 captive screw; calibration data (level 2)



### Key features

- Measures three axes at a single mounting location for faster, more efficient data collection
- Manufactured in ISO 9001 facility

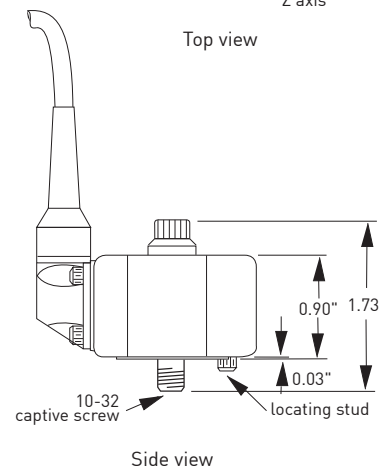
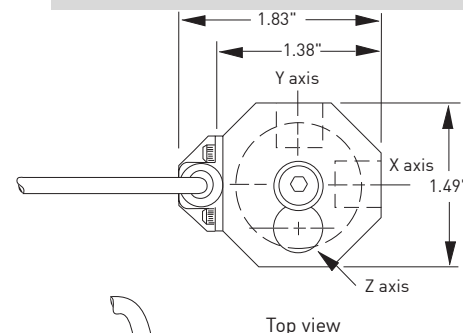

Note: Due to continuous process improvement, specifications are subject to change without notice.  
This document is cleared for public release.

Connections	
Function	Cable conductor color
axis X, power/signal	green
axis Y, power/signal	red
axis Z, power/signal	white
common (all channels)	black
N/C	shield