

# High temperature accelerometer

## HT787A

**Danetech srl**  
 20017 Rho (Mi) - via Magenta, 77 - Edif. 6  
 Tel. 02 36569371 - Fax 02 36569382  
 @: info@danetech.it - web: www.danetech.it

### SPECIFICATIONS

|  |                  |   |
|--|------------------|---|
| Sensitivity, $\pm 5\%$ , 25°C              |                  | 100 mV/g  |
| Acceleration range, VDC > 25 V             |                  | 80 g peak   |
| Amplitude nonlinearity                     |                  | 1%  |
| Frequency response:                        | $\pm 10\%$       | 1.0 - 5,000 Hz  |
|  | $\pm 3$ dB       | 0.5 - 10,000 Hz   |
| Resonance frequency, nominal               |                  | 22 kHz  |
| Transverse sensitivity, max                |                  | 5% of axial   |
| Temperature response:                      | -25°C            | -10%  |
|  | +150°C           | +15%  |
| Power requirement:                         |                  |   |
| Voltage source                             |                  | 18 - 30 VDC   |
| Current regulating diode                   |                  | 2 - 10 mA   |
| Electrical noise, equiv. g:                |                  | <b>25°C</b> <b>150°C</b>                                      |
| Broadband                                  | 2.5 Hz to 25 kHz | 700 $\mu$ g      1,100 $\mu$ g                                |
| Spectral                                   | 10 Hz            | 10 $\mu$ g/ $\sqrt{\text{Hz}}$ 14 $\mu$ g/ $\sqrt{\text{Hz}}$ |
|  | 100 Hz           | 5 $\mu$ g/ $\sqrt{\text{Hz}}$ 7 $\mu$ g/ $\sqrt{\text{Hz}}$   |
|  | 1,000 Hz         | 5 $\mu$ g/ $\sqrt{\text{Hz}}$ 7 $\mu$ g/ $\sqrt{\text{Hz}}$   |
| Output impedance, max                      |                  | 100 $\Omega$  |
| Bias output voltage:                       | +25°C            | 13 VDC  |
|  | +150°C           | 12 VDC  |
| Grounding                                  |                  | case isolated, internally shielded                            |
| Temperature range                          |                  | -50° to +150°C  |
| Vibration limit                            |                  | 500 g peak  |
| Shock limit                                |                  | 5,000 g peak  |
| Electromagnetic sensitivity, equiv. g, max |                  | 70 $\mu$ g/gauss  |
| Sealing                                    |                  | hermetic  |
| Base strain sensitivity, max               |                  | 0.0002 g/ $\mu$ strain  |
| Sensing element design                     |                  | PZT, shear  |
| Weight                                     |                  | 145 grams   |
| Case material                              |                  | 316L stainless steel  |
| Mounting                                   |                  | 1/4-28 captive screw  |
| Output connector                           |                  | 2 pin, MIL-5015 style   |
| Recommended cabling                        |                  | J9F / J9T2A   |

Accessories supplied: 1/4-28 captive screw (metric mounting available); calibration data (level 2)



### Key features

- 150°C operation
- Built with extended range components for long-lasting operation
- Manufactured in ISO 9001 facility

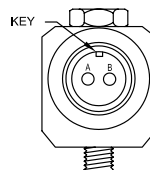
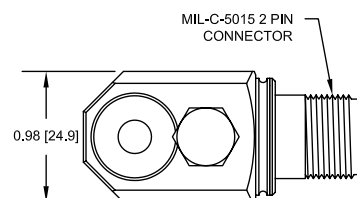
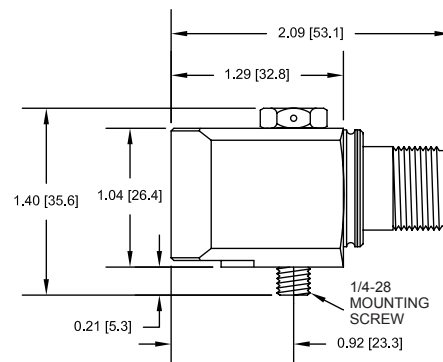

| Connections  |               |
|--------------|---------------|
| Function     | Connector pin |
| power/signal | A             |
| common       | B             |
| ground       | shell         |

Note: Due to continuous process improvement, specifications are subject to change without notice. This document is cleared for public release.